

Open Home
Fri 7 & Sat 8 June, 11am-3pm



Welcome to the friendly boutique community of Lansdowne Park, offering resort style facilities, mature gardens and stunning views of the Tararua Ranges.

At Lansdowne Park you'll enjoy the freedom to pursue your own interests, make new friends and relax in comfort, knowing that your home and garden is well maintained and taken care of for you. We have a range of accommodation options that offer personalised care packages that can be tailored to your specific needs, so why not pop in and take a look for yourself? We'd love the opportunity to have a chat and show you around our unique community.

Open Home
 Rest Home, Hospital and
 Serviced Studio rooms available now



Serviced Studios from only \$175,000*

Our studios are comfortable, warm and bathed in natural light. Each is equipped with a kitchenette, spacious bathroom and ample storage. These homes are designed so you can receive tailored care to support your independence and have more time for the things you love. Our care packages range from independent to resthome level.

Our Sales Manager Wendy Riley will be on-site during the open days or to make an appointment call Wendy on 06 377 0123 or 0272 804 065 or email wendy.riley@lansdownepark.co.nz

** Licence to Occupy.*

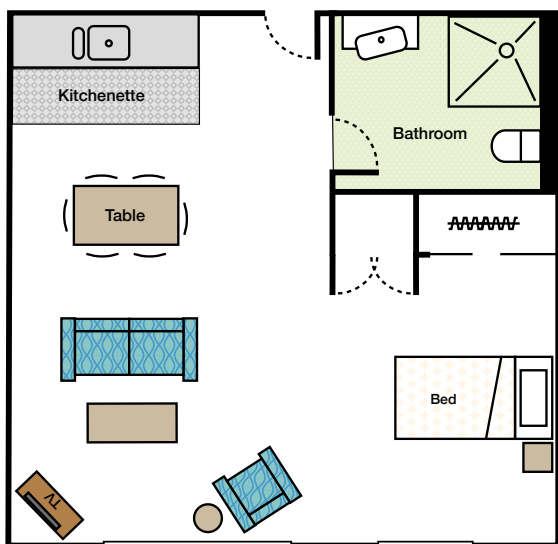

Typical Studio Floorplan

On-site Care Centre

We're immensely proud of the quality of care and support we provide our rest home and hospital residents. Each room has an ensuite bathroom, lovely garden views and room for some of your favourite furniture and personal belongings.

If you think you may need more support in the future, or if you're looking for a caring home for a loved one, why not pop in and see our Manager Karen Scott this Friday or Saturday. We'd love to see you.

